

NOTE: UTILITY RELOCATION DESIGN IS ON-GOING BY THE UTILITIES AND WILL BE FINALIZED ONCE THE HORIZONTAL LAYOUT OF THE INTERSECTION IS FINALIZED.

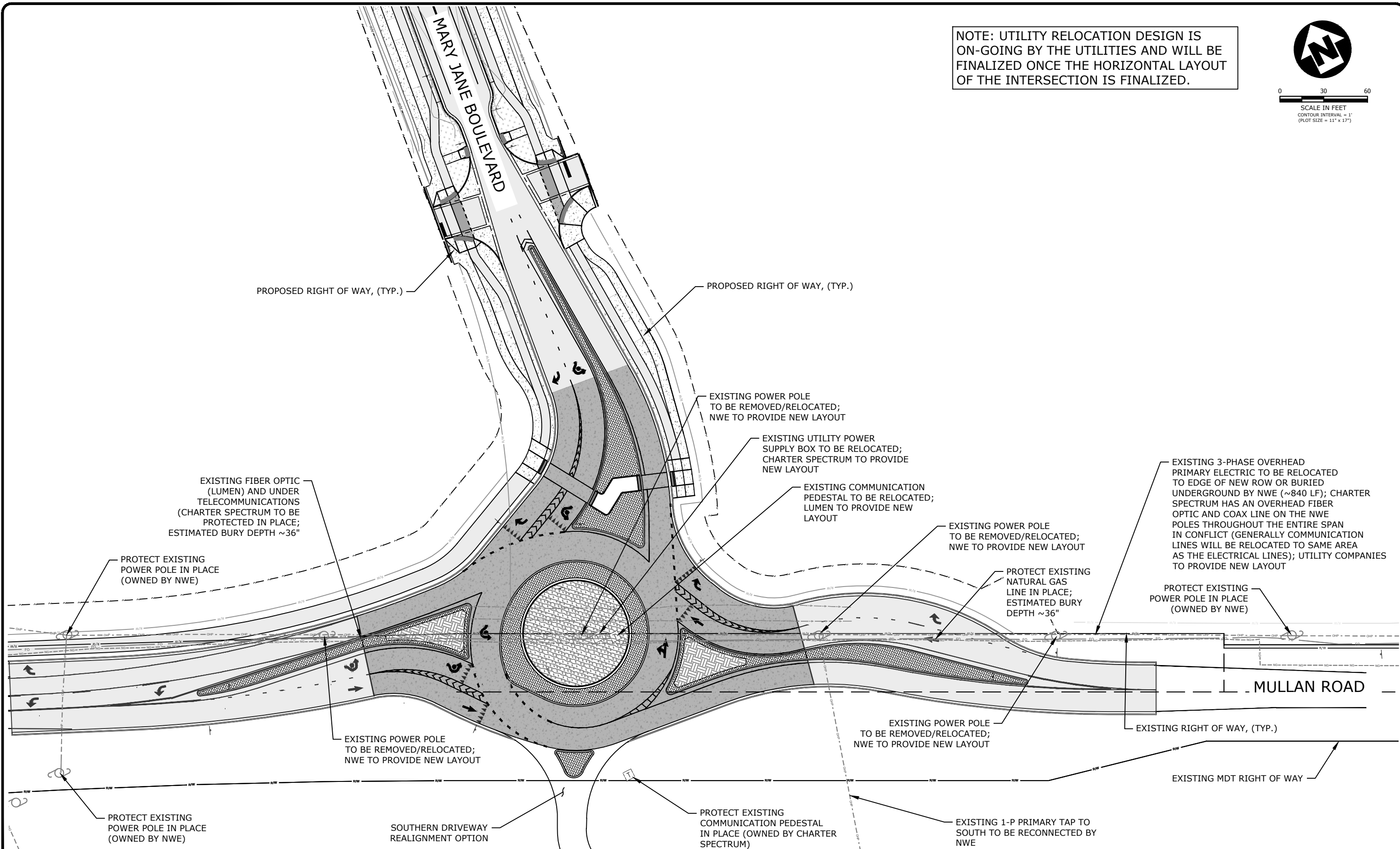

0 30 60
SCALE IN FEET
CONTOUR INTERVAL = 1'
(PLOT SIZE = 11" x 17")



REVISION	DATE	DESCRIPTION

DESIGNER	BE	PROJ. NO.	7065
DRAWN	BE	DATE	01/2021
CHECKED	BE	SURVEYED	DJ&A, P.C.



ENGINEERS
PLANNERS
SURVEYORS

MULLAN BUILD

MARY JANE BOULEVARD &
MULLAN ROAD INTERSECTION
PRIVATE UTILITIES

SHEET	OF
M.1	M.2

NOTE: UTILITY RELOCATION DESIGN IS ON-GOING BY THE UTILITIES AND WILL BE FINALIZED ONCE THE HORIZONTAL LAYOUT OF THE INTERSECTION IS FINALIZED.

SCALE IN FEET
 0 30 60
 CONTOUR INTERVAL = 1'
 (PLOT SIZE = 11" x 17")

PROPOSED RIGHT OF WAY, (TYP.)

EXISTING UNDERGROUND FIBER OPTIC AND TELEPHONE TO BE PROTECTED IN PLACE; ESTIMATE BURY DEPTH ~36" (OWNED BY LUMEN AND CHARTER SPECTRUM)

EXISTING NATURAL GAS MAIN TO BE PROTECTED IN PLACE; ESTIMATE BURY DEPTH ~36" (OWNED BY NWE)

EXISTING GAS VALVE TO BE ADJUSTED TO FINISH GRADE (OWNED BY NWE)

EXISTING POWER POLE TO BE REMOVED/RELOCATED; MEC TO PROVIDE NEW LAYOUT; CHARTER SPECTRUM GOES FROM OVERHEAD TO UNDERGROUND AT THIS POWER POLE

PROTECT EXISTING POWER POLE IN PLACE (OWNED BY MEC)

MULLAN ROAD ACCESS

EXISTING 1-P PRIMARY TAP TO SOUTH TO BE RECONNECTED BY MEC

PROTECT EXISTING COMMUNICATION PEDESTALS IN PLACE (OWNED BY LUMEN)

EXISTING NATURAL GAS MAIN TO BE PROTECTED IN PLACE ESTIMATE BURY DEPTH ~36" (OWNED BY NWE)

EXISTING 3-PHASE OVERHEAD PRIMARY ELECTRIC TO BE RELOCATED TO EDGE OF NEW ROW OR BURIED UNDERGROUND BY MEC (~770 LF); CHARTER SPECTRUM HAS AN OVERHEAD FIBER OPTIC AND COAX LINE ON THE MEC POLES THROUGHOUT THE ENTIRE SPAN IN CONFLICT (GENERALLY COMMUNICATION LINES WILL BE RELOCATED TO SAME AREA AS THE ELECTRICAL LINES); UTILITY COMPANIES TO PROVIDE NEW LAYOUT

EXISTING POWER POLE TO BE REMOVED/RELOCATED; MEC TO PROVIDE NEW LAYOUT

EXISTING OVERHEAD ELECTRICAL SERVICE TO BE RECONNECTED BY MEC

PROTECT EXISTING LIFT POLE IN PLACE (OWNED BY MEC)

EXISTING RIGHT OF WAY, (TYP.)

EXISTING POWER POLE TO BE REMOVED/RELOCATED; MEC TO PROVIDE NEW LAYOUT

EXISTING OVERHEAD ELECTRICAL SERVICES TO BE RECONNECTED BY MEC

SOUTHERN FRONTAGE ROAD CONSTRUCTION

MULLAN ROAD ACCESS

MULLAN ROAD

GEORGE ELMER DRIVE

MARIE DRIVE

REVISION	DATE	DESCRIPTION	DESIGNER <u>BE</u>	PROJ. NO. <u>7065</u>	<div><div>DP &D</div><div>ENGINEERS PLANNERS SURVEYORS</div></div>	MULLAN BUILD	George Elmer Drive & Mullan Road Intersection Private Utilities	SHEET	
			DRAWN <u>BE</u>	DATE <u>01/2021</u>				OF	
			CHECKED <u>BE</u>	SURVEYED <u>DJ&A P.C.</u>				M.2	M.2